

Pelli Clarke Pelli Architects

Cooperative Arts and Humanities High School

Location	New Haven, Connecticut
Total Area	140,000 square feet
Date of Completion	2009
Client	Board of Education, City of New Haven

New Haven's Cooperative Arts and Humanities High School is a state-of-the-art facility for performance and education in the midst of the city's bustling arts and entertainment district. It includes a full-sized public theater, a black box experimental theater, and exhibition spaces and all of the elements of a traditional high school, including a gymnasium, cafeteria, and classrooms. To maintain a lively street presence, the building has retail stores on the ground floor and direct public access to the theater lobby and galleries.

One block south of the New Haven Green, the school is close to the Shubert Theater, the Yale Repertory Theater, Yale's art galleries and its schools of Architecture, Art, Music, and Drama. With theaters, exhibit spaces, and studios that can be shared, the building makes it possible for the school and local arts institutions to collaborate.

The building's design is a modern take on traditional urban school architecture, interpreted for a busy commercial neighborhood. The long College Street façade is a composition of brick masses, glass volumes, and steel planes. At the corner of College and Crown, a double-height glass dance studio is a "marquee" for the arts-focused program. Similarly, the abstracted maple, oak and elm leaves silkscreened on the insulated glass panels of the College Street façade reference the drawing, painting and printmaking studios inside. This patterned glass helps reduce the building's energy consumption by letting in light while reducing solar gain.

The heart of the school is a 350-seat theater, complete with orchestra and balcony seating, an orchestra pit, scene shop, costume storage, dressing rooms, and loading dock. The theater features a sprung stage with a full fly loft, professional theater lighting, and a projection and control booth. In addition, the school includes rehearsal rooms, a ceramic studio, a photography darkroom, a graphic lab, a score library, a keyboard lab, a film and lecture hall, and creative writing rooms.

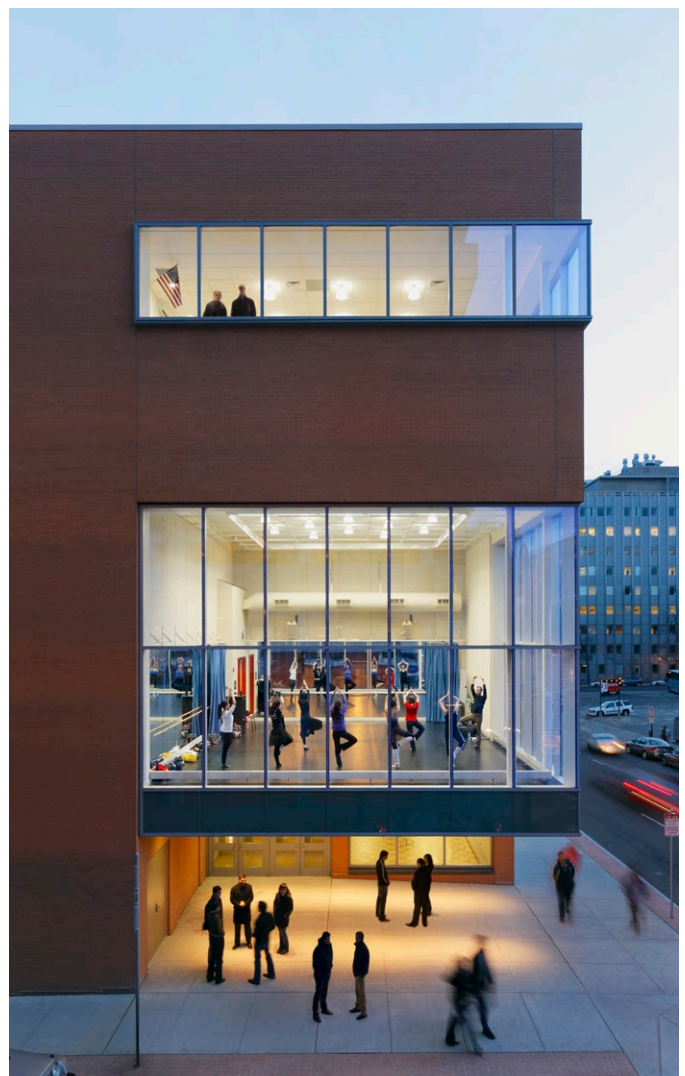

Cooperative Arts and Humanities High School

